

## J. LaPorte & Associates

Facilities Planning \* Architecture \* Project Management  
514 Sligh Blvd NE. Grand Rapids, Michigan 49505 \* Ph/Fax 616-364-5800

# Medical Office Building

**Marshall Internal Medicine PC.**  
**Marshall, Michigan**

### Project Profile

**Architect:** J. LaPorte & Assoc.

**Consultants:** None

**Facility Type:** Health Care

### Project Information

**Square Feet:** 8800 SF

**Date occupied:** Fall, 1993

**Number of Floors:** Two

**Construction Cost  
Per Square Foot:** \$66/SF

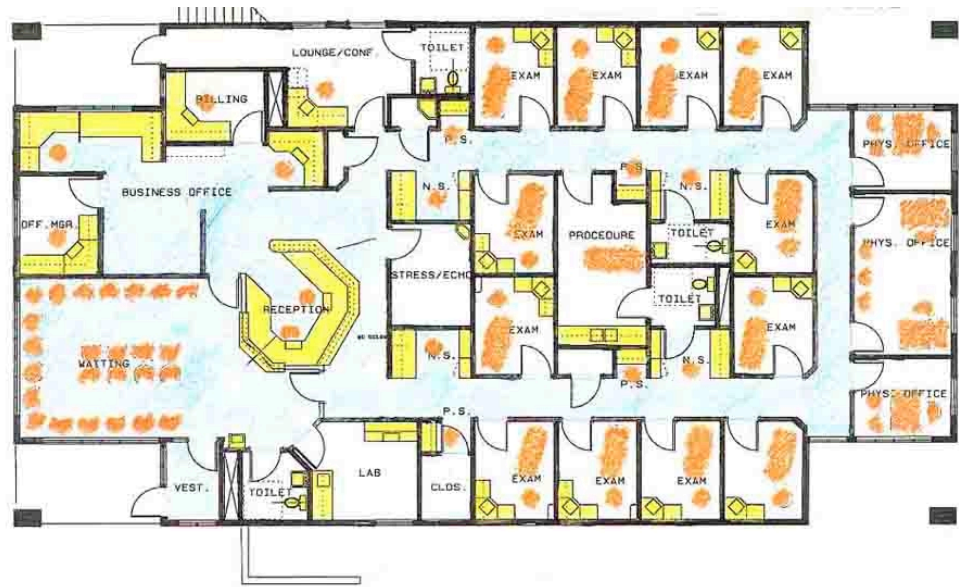

**MAIN LEVEL FLOOR PLAN**  
(full unfinished walkout basement)

### Project Highlights

- New construction on a rolling site
- 4400 SF finished first floor
- 1400 SF lower level storage/mech.
- 3000 SF lower unfinished

